

## SMARTCODE™ 910 DEADBOLT FEATURING Z-WAVE® 500 CHIPSET

Model #: 910

Function: Single Cylinder Electronic Deadbolt



### Convenience

- Backlit keypad with one-touch locking
- Motorized locking mechanism enables true remote locking & unlocking
- Tapered deadbolt design permits misaligned doors to lock & unlock with ease
- SmartKey® easy re-key backup keyway
- Interior LED status indicator—Locked/Unlocked status & low battery status
- Auto re-lock feature—locks door 30-seconds after unlocking

### Security

- 30 user access code capacity, 4-8 digit code length
- 128-bit Advanced Encryption Standard (AES) communication
- Meets BHMA Grade 2 deadbolt operational and security standards
- Drill and pick resistant backup keyway with BumpGuard™ protection
- Independent, local user authentication - No controller connectivity required
- User settings stored on lock memory - settings remain even in case of a power outage

### Customizable Features

- Auto re-lock 30-seconds after unlocking - ON/OFF
- Interior LED locked/unlocked status - ON/OFF
- Audible feedback - ON/OFF

### Specifications

#### Electrical:

**Input Power** 6V (4 x AA alkaline batteries)

#### Mechanical:

**Door Prep** 2 1/8" diameter face hole & 1" diameter latch hole

**Backset** Adjustable 2 3/8" or 2 3/4"

**Door Thickness** 1 3/8" - 2" automatic adjustment

**Faceplates** 1" x 2 1/4" round corner standard

**Strikes** Round corner strike 2 3/4" x 2 1/8"

**Latch** Round corner adjustable 2 3/8" x 2 3/4"

**Bolt** 1" throw, steel deadbolt

**Door Handing** Reversible

**Cylinder** SmartKey Security™

#### Environmental:

**Temperature Range** Exterior: -40°F to 150°F  
Interior: 32°F to 140°F

**Humidity** Exterior: 100% condensing  
Interior: 99% non-condensing

**SMARTCODE 910**  
TOUCHPAD ELECTRONIC DEADBOLT  
With Z-Wave® 500 Chipset



### Wireless Communication

- Z-Wave® wireless technology
- RF Operation: 908.42 MHz (US)
- Range: Typical 100ft line of sight



### Electronic Compliance

- Z-wave
- FCC Part 15
- Industry Canada
- Australia-New Zealand

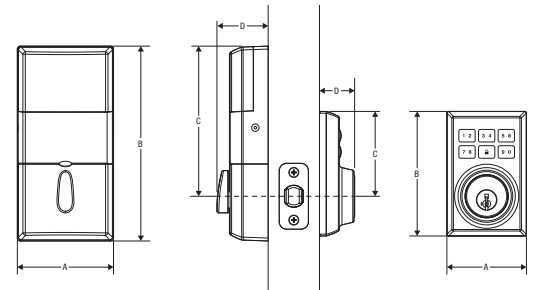

Design	A	B	C	D
Interior	3 9/32" (83.34 mm)	6 21/32" (169.07 mm)	5 1/8" (130.18 mm)	1 3/4" (44.45 mm)
Exterior	2 3/4" (69.85 mm)	4 1/4" (107.95 mm)	3" (76.20 mm)	1 7/32" (30.96 mm)

### Command Classes

#### Supported Command Classes:

- COMMAND\_CLASS\_MANUFACTURER\_SPECIFIC
- COMMAND\_CLASS\_VERSION
- COMMAND\_CLASS\_SECURITY
- COMMAND\_CLASS\_BATTERY
- COMMAND\_CLASS\_ASSOCIATION
- COMMAND\_CLASS\_CONFIGURATION
- COMMAND\_CLASS\_PROTECTION
- COMMAND\_CLASS\_DOOR\_LOCK
- COMMAND\_CLASS\_USER\_CODE
- COMMAND\_CLASS\_SCHEDULE\_ENTRY\_LOCK
- COMMAND\_CLASS\_DOOR\_LOGGING
- COMMAND\_CLASS\_ALARM
- COMMAND\_CLASS\_TIME\_PARAMETERS
- COMMAND\_CLASS\_BASIC

#### Lock Initiated Event Notifications:

- Lock secured using cylinder or inside turnpiece
- Lock un-secured using keyed cylinder or inside turnpiece
- Lock auto secured - Bolt jammed (not fully extended)
- Lock auto secured - Successful (fully extended)
- Lock un-secured by user (User-ID) at keypad
- Lock secured by user (User-ID) at keypad or lock button
- Lock secured by controller - Bolt jammed (not fully extended)
- Lock secured by controller - Successful (fully extended)
- Lock un-secured by controller - Successful (fully retracted)
- New user code (User-ID#) added to the lock
- All user codes deleted from lock
- Failed user code attempt at keypad
- Attempted access by user (User-ID#) outside of scheduled date/time
- Low battery level
- Critical battery level
- Battery level too low to operate deadbolt